



PASCO Specialty & Mfg., Inc.

11156 Wright Road
Lynwood, CA 90262
Phone (310) 537-7782
Fax (800) 737-2726

7529 Perryman Court
Curtis Bay, MD 21226
Phone (410) 360-5010
Fax (877) 377-6466

www.pascospecialty.com

TECHNICAL SPECIFICATION SUBMITTAL

Lead free chrome plated brass drinking fountain for use on enamel cast iron, china or stainless steel fountain bowls

Job Name _____ Date _____

Model Specified _____ Quantity _____

Customer/Wholesaler _____

Contractor _____

Architect/Engineer _____

Engineering Specification: Lead free chrome plated brass drinking fountain with push button and replaceable lead free plastic operating cartridge. For specific use on wall hung drinking fountains with drain bowls.

Lead Free Chrome Plated Brass Drinking Fountain Retro Fit Assembly

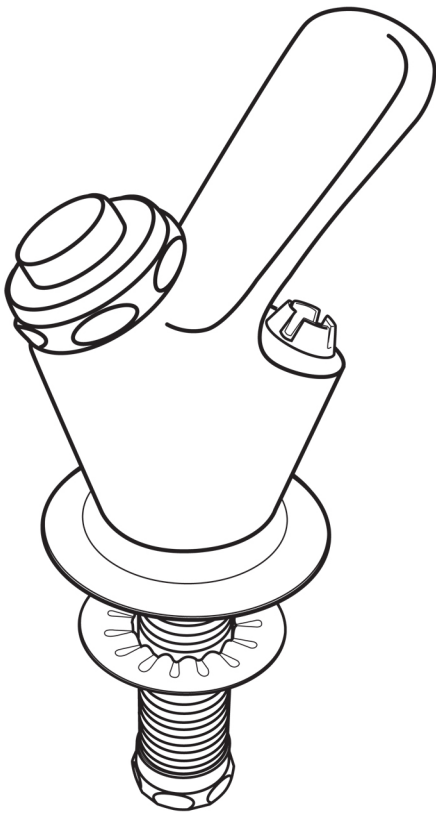

- 1/2" MPT X 3/8" (body inlet) x 3-1/2" stainless steel nipple
- Cartridge has adjustable flow rate feature
- Replace outlet spout
- Stainless steel flange covers various size holes in fountain bowl
- 1-3/4" cover for old handle hole in fountain bowl
- Replacement cartridge number 2195

Complies:
• ANSI/NSF 61 Annex G

Part Number 2197
Part Number 86197*

*LEAD FREE

2195 Cartridge for either fountain head



- Flow rate adjustment screw
- Acetal plastic
- Complies: CA AB1953 and VT S.0152

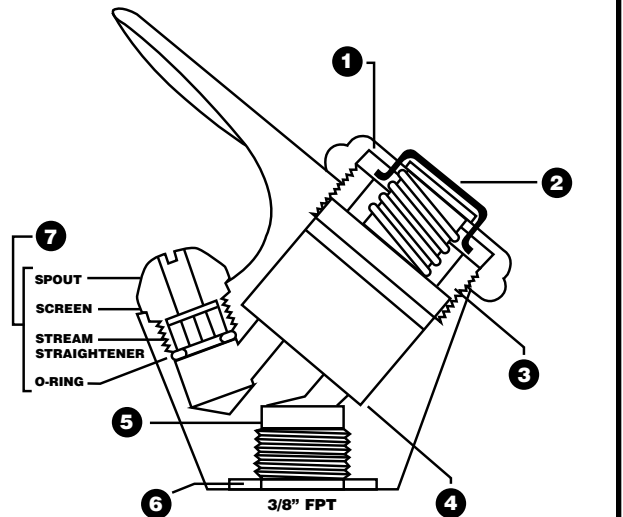

INDUSTRY EQUALS

| | |
|---------------|------------|
| HAWS | HW5010 |
| EBCO | 024572-001 |
| SUNROC | AD19447-SP |
| HALSEY TAYLOR | 3041 |
| TOMLINSON | 1016448 |

- 1. Chrome collar (2194-1)
- 2. Chrome button (2194-2)
- 3. Brass bushing (2194-3)
- 4. Valve gasket (2194-4)
- 5. Inlet screen (2194-5)
- 6. Inlet washer (2194-6)
- 7. Mouthpiece set (2194-M)